

The Air Transfer valve allows the slug of air trapped in the fill line between the delivery tanker and submerged drop tube exit to escape into the tank ullage, instead of being pressurised and forced through the stored product in the tank.

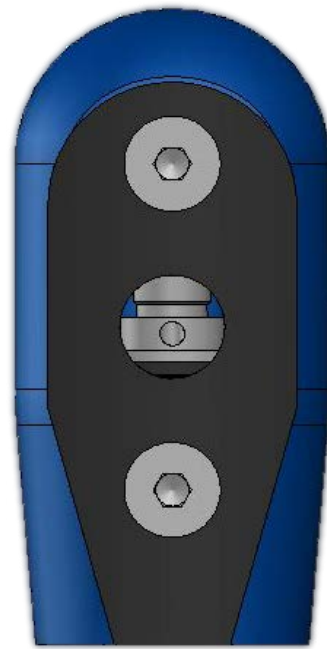

Pt No. RIS-ATV

ADVANTAGES:

- Reduced creation of vapour
- Reduces turbulence of fuel in the storage tank
- Faster delivery cycle
- Reduced risk of fill line lock-ups and blow-backs
- Prevents aeration of suction lines and loss of pump prime

The Patented RIS-ATV can be easily installed on site, with new or existing removable drop tubes. RIS-ATV valves are compatible with both RIS-STOP and other makes of Overfill Prevention Devices.

Materials:

Anodised Aluminium
Stainless Steel
Viton

Suitable for:

Petroleum Spirit (including
Ethanol Blends up to 90%)
Diesel
Bio Diesel / FAME Blends
AvGas and Jetfuel

Document Ref:

DATA-RIS-ATV-140812